

Building 1
± 685,080 SF

Building 2
± 249,480 SF

Current Status

For Lease

Matter Logistics @ North 15

Meticulously planned industrial warehouse space.

Matter.

Colliers



[Click Here to Watch Marketing Video](#)

Location Highlights

Northeast corner of E. North Belt Road and Nicco Way, North Las Vegas, NV

- Located in the heart of the North Las Vegas Speedway Submarket
- Close proximity to Harry Reid International Airport, I-15 & 215 Freeways
- Less than 20 minutes to the Las Vegas Strip
- Access to serving over 77 million+ people within a one-day truck drive.

Project Highlights

- ± 42.68 Acres
- 2 Buildings
- ± 934,560 Total SF
- M-2 Industrial Zoning
- Industrial & Warehouse Uses
- Cross Dock & Rear Loading Configuration
- Grade Level & Dock High Loading Doors
- ± 32'-40' Clear Height
- Trailer Parking
- Concrete Tilt Up Construction
- ESFR Fire Protection Systems
- Clerestory Windows
- Utility Providers: NV Energy, Southwest Gas, & Cox
- Estimated Delivery Q3 2023





Matter Logistics
@ North 15
For Lease
5850 & 5880 E. North Belt Road
± 249,480 SF - ± 685,080 SF



Matter Logistics @ North 15

Building 1 - ± 685,080 SF
5850 E. North Belt Road

Building Specifications

- ± 685,080 SF
- Divisible to ± 162,589 SF (Can Combine Suites)
- 4 Grade Level Doors (14' x 16')
- 100 Dock High Doors (9' x 10')
- Office BTS or Spec Suite
- ± 40' Clear Height
- Approximately 50' X 56' Bays and 60' Typical Speed Bays
- ± 185' truck court with a 60' concrete dock apron
- ± 8,000 Amps/Building, 277/480 V
- TPO Roof
- 7" Thick 4500 PSI Floor Slabs
- R-19 Insulation
- 214 Skylights
- Parking Provided: 527 Stalls
- 69 Trailer Stalls

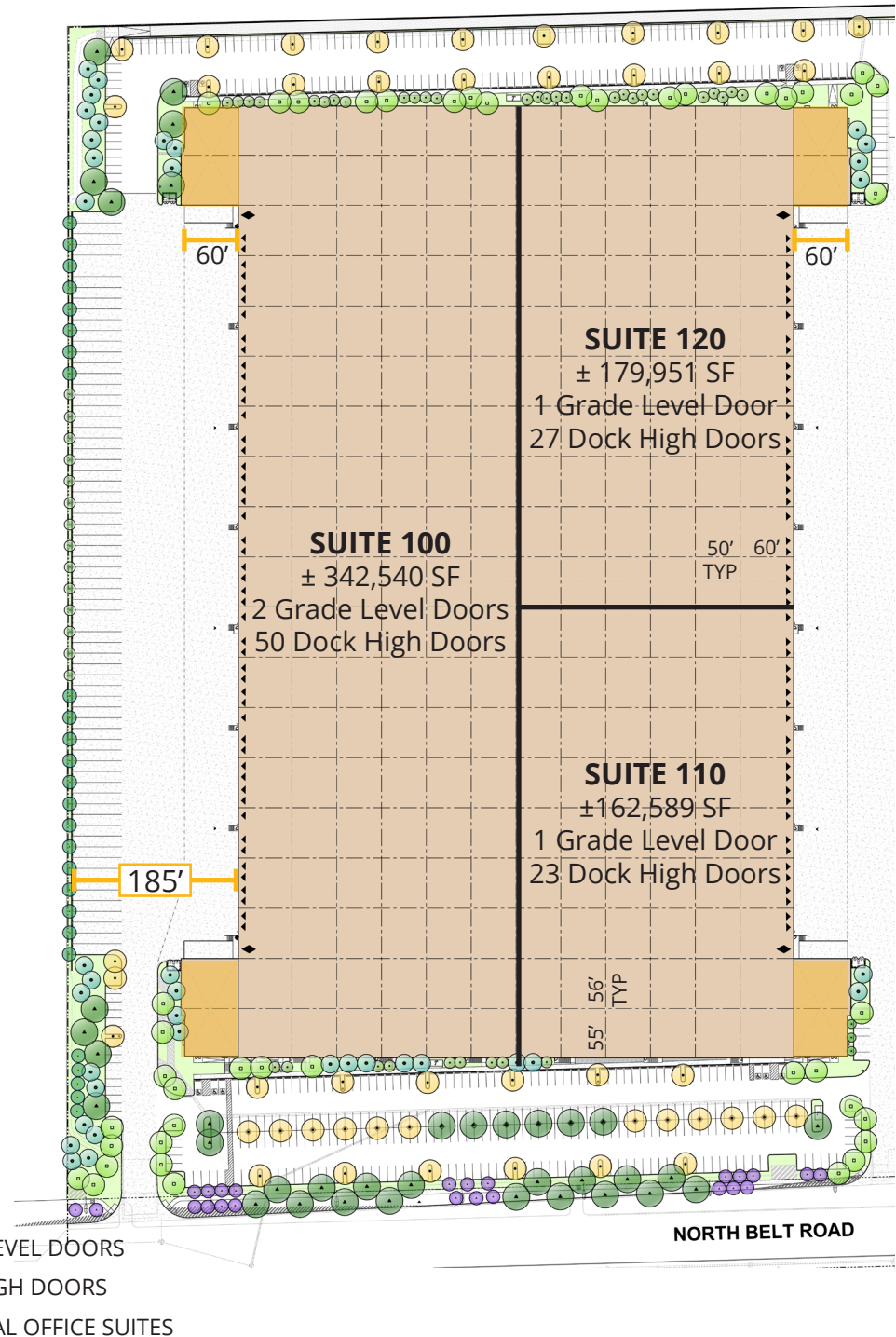

Matter Logistics @ North 15

Building 1 - ± 685,080 SF
5850 E. North Belt Road

Building Specifications

- ± 685,080 SF
- Divisible to ± 162,589 SF (Can Combine Suites)
- 4 Grade Level Doors (14' x 16')
- 100 Dock High Doors (9' x 10')
- Office BTS or Spec Suite
- ± 40' Clear Height
- Approximately 50' X 56' Bays and 60' Typical Speed Bays
- ± 185' truck court with a 60' concrete dock apron
- ± 8,000 Amps/Building, 277/480 V
- TPO Roof
- 7" Thick 4500 PSI Floor Slabs
- R-19 Insulation
- 214 Skylights
- Parking Provided: 527 Stalls
- 69 Trailer Stalls

POTENTIAL DIVISIBILITY

CONTINUED

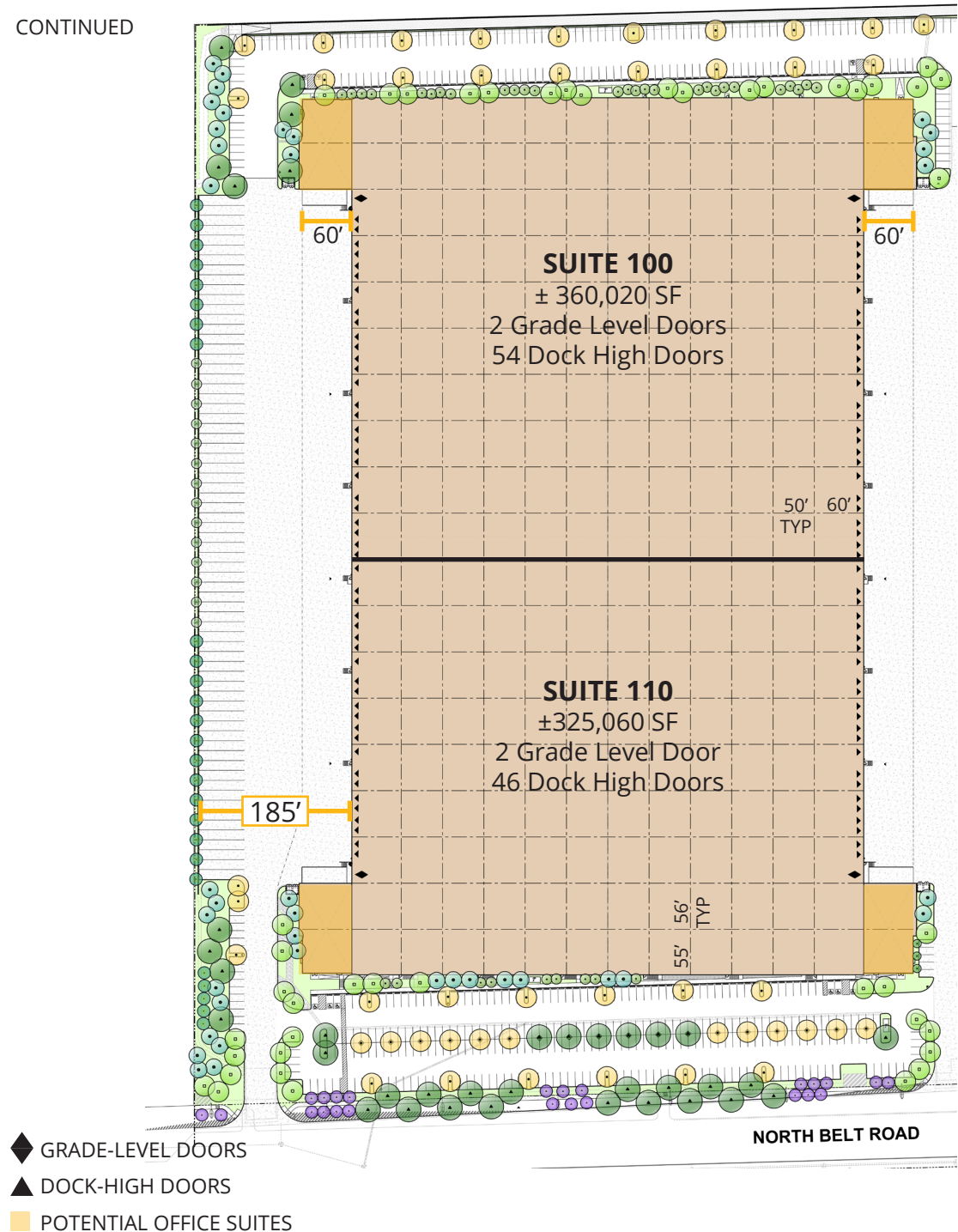

Matter Logistics @ North 15

Building 2 - ± 249,480 SF
5880 E. North Belt Road

Building Specifications

- ± 249,480 SF
- Divisible to ± 56,681 SF (Can Combine Suites)
- 4 Grade Level Doors (14' x 16')
- 56 Dock High Doors (9' x 10')
- Office BTS or Spec Suite
- ± 32' Clear Height
- Approximately 50' X 54' Bays and 60' Typical Speed Bays
- ± 210' Concrete Truck Court
- ± 4,000 Amps/Building, 277/480 V
- TPO Roof
- 6" Thick 4500 PSI Floor Slabs
- R-19 Insulation
- 77 Skylights
- Parking Provided: 277 Stalls

*Can be combined

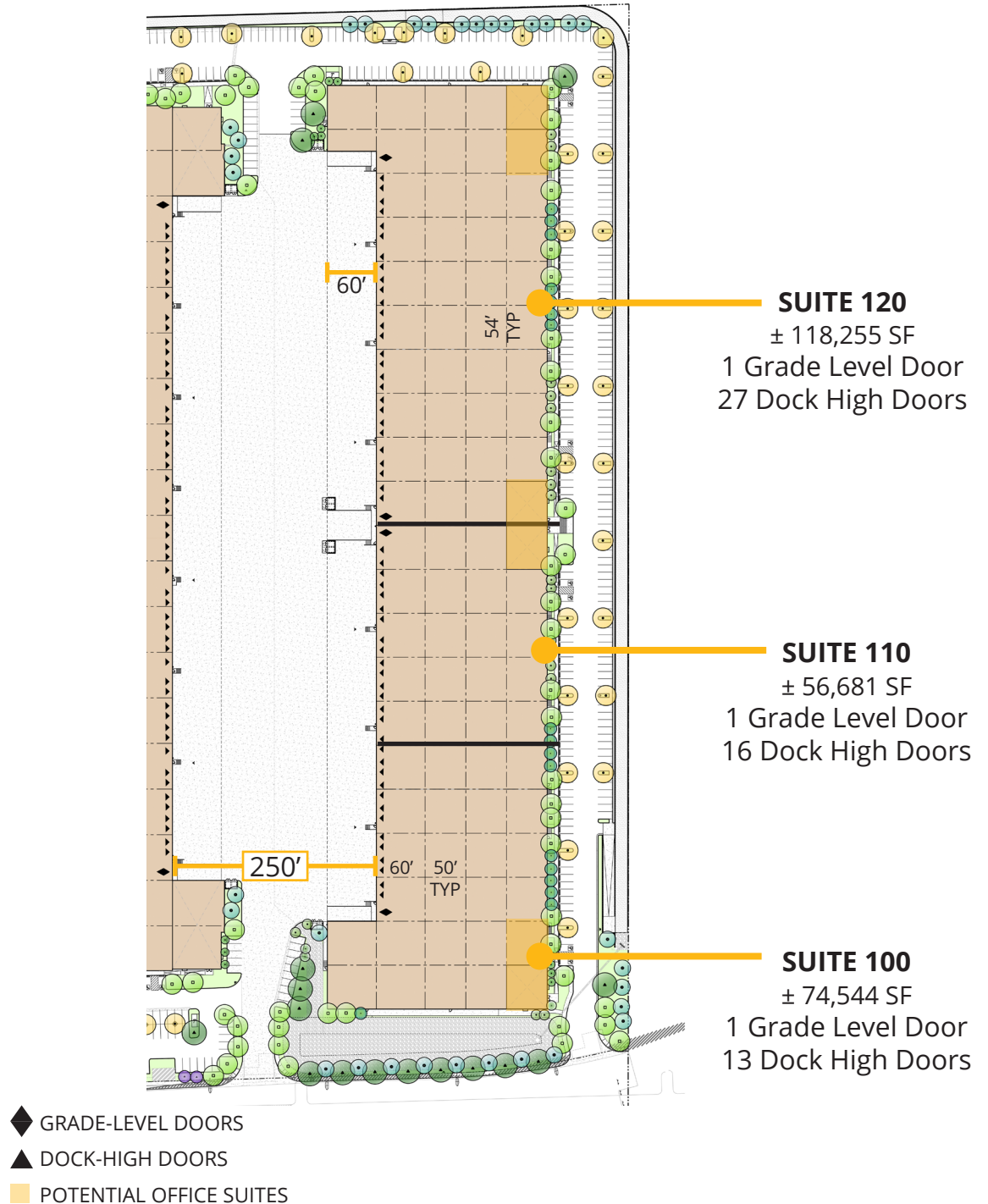



Employee Amenities

Fully shaded outdoor dining and relaxation area located at each building for employee use.

Amenity Areas

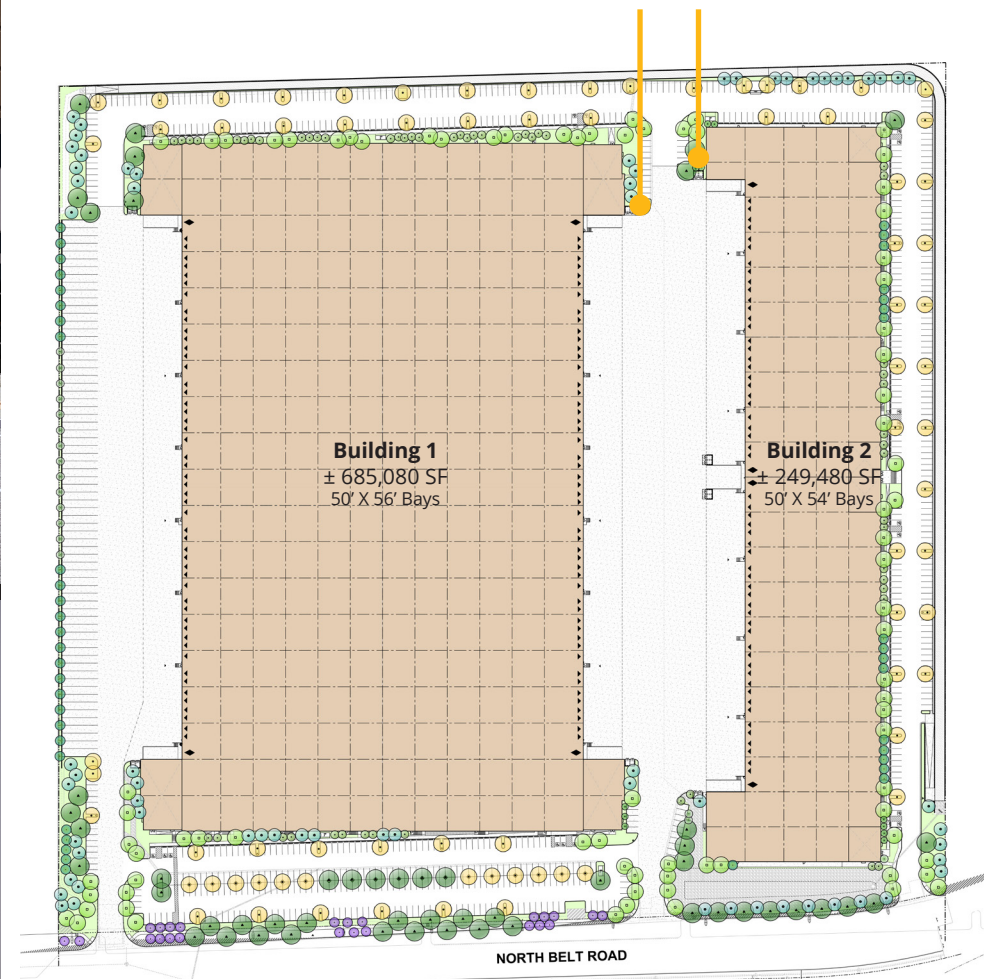



Leasing Contact

Paul Sweetland, SIOR
Colliers International
leasing by Doherty
Industrial Group
paul.sweetland@colliers.com
702-836-3750
License # NV-S.0043604

Leasing Contact

Dan Doherty, SIOR
Colliers International
leasing by Doherty
Industrial Group
dan.doherty@colliers.com
702-836-3707
License # NV-S.24287

Leasing Contact

Chris Lane, SIOR, CCIM
Colliers International
leasing by Doherty
Industrial Group
chris.lane@colliers.com
702-836-3728
License # NV-S.0166896

Matter.

Ownership Contact

Tom van Betten
Vice President
of Strategic Partnerships
tom.vanbetten@matterrealestate.com
619-379-3500
Matter Real Estate Group
matterrealestate.com

The information furnished has been obtained from sources we deem reliable and is submitted subject to errors, omissions and changes. Although Colliers Nevada, LLC, Matter Real Estate Group and related entities have no reason to doubt its accuracy, we do not guarantee it. All information should be verified by the recipient prior to lease, purchase, exchange or execution of legal documents.